

VENTOSAS
VACUUM CUPS

PROFUNDAS
DEEP

VSA I



CARACTERÍSTICAS · CHARACTERISTICS

Ø reposo / Ø trabajo Ø unloaded / Ø loaded	[mm]
Mín. radio de curvatura Minimum curve radius	[mm]
Carrera máxima Maximum stroke	[mm]
Volumen Volume	[cm³]
Peso Weight	[g]
Fuerza a -0,4 bar Force at -0,4 bar	[Kgf]
Fuerza a -0,6 bar Force at -0,6 bar	[Kgf]
Fuerza a -0,8 bar Force at -0,8 bar	[Kgf]
Fuerza a -0,9 bar Force at -0,9 bar	[Kgf]

CÓMO PEDIR · HOW TO ORDER

● Ventosa de nitrílo con racor integrado
Nitrile vacuum cup with integrated fitting

ADECUADAS PARA
SUITABLE FOR

Superficies esféricas
Spherical surfaces

Superficies curvadas
Curved surfaces

VENTAJAS
ADVANTAGES

Forma cóncava profunda
Deep concave shape

Estructura robusta
Sturdy structure

Racor integrado
Integrated fitting

Ø 31

Ø 46

Ø 63

Ø 85

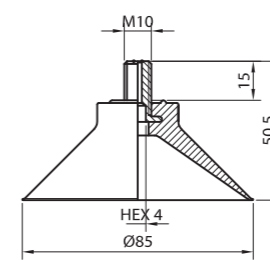
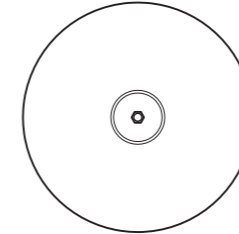
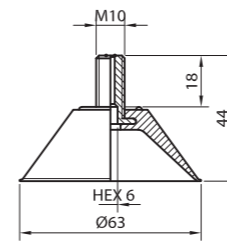
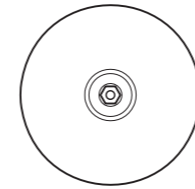
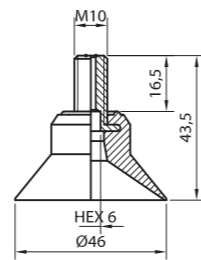
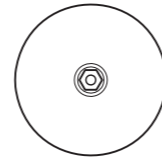
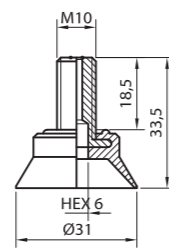
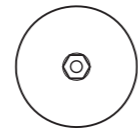

31 / 36,5

46 / 49

63 / 72

85 / 91,5

15,5

25

22,5

45

5

7,5

9,5

14,5

5

12

29

58

16

25

28

48

2,02

5,16

9,32

15,2

3,13

7,22

12,6

20,7

4,21

9,11

15,4

24,9

4,73

10,1

16,6

26,7

VSA31M10NIT

VSA46M10NIT

VSA63M10NIT

VSA85M10NIT